

1 2 3 4 5 6 7 8

E

E

D

D

C

C

B

B

A

A

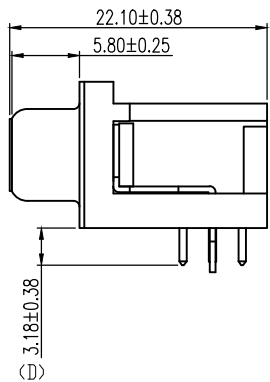
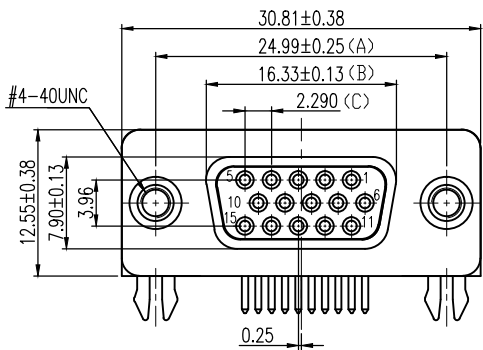

SPECIFICATIONS

- 1. D-SUB
- 1.1 Voltage: 250 VAC(RMS) Max.
- 1.2 Current Rating: 3 Ampere per Contact
- 1.3 Contact Resistance: 25 Milliohms Max.
- 1.4 Insulation Resistance: 5000 Megohms Min.
- 1.5 Dielectric Withstanding Voltage: 1000V AC(RMS)
- 1.6 Total Mating Force: 6.0 Kgf Max.
- 1.7 Total Unmating Force: 1.2 Kgf Min.
- 1.8 Operating Temperature: -55°C to +85°C

NOTES

- 1. MATERIAL:
 - Housing:PA9T, UL 94V-0, Color:Black.
 - Terminal:Copper Alloy.
 - Shell:SPCC.
 - Boardlock:Copper Alloy.
 - Rivet:Copper Alloy.
 - Screw:Copper Alloy.
- 2. FINISH:
 - Terminal:Gold Plated over Nickel at Contact Area.
 - Tin Plated over Nickel at Solder Area.
 - Shell:Nickel Plated.
 - Boardlock:Tin Plated.
 - Rivet:Nickel Plated.
 - Screw:Nickel Plated.
- 3. This Product is LEAD-FREE & RoHS Compliance Product.

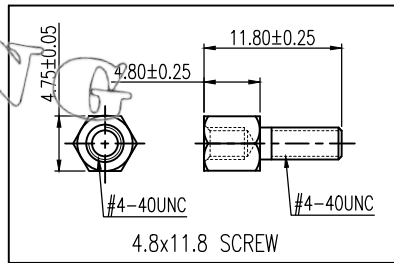
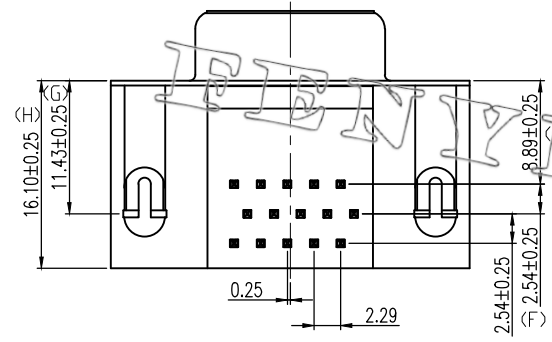

D112XXX XXXXXXXXNO

- SERIES NO. _____
- NUMBER OF POSITION _____
- CONTACT STYLE _____
- CONTACT MATERIALS _____
- CONTACT FINISH _____
- FRONT SHELL FINISH _____
- INSULATOR MATERIALS _____
- COLOR STYLE _____
- FLANGE MOUNTING OPTION _____
- BOARD MOUNTING OPTION _____

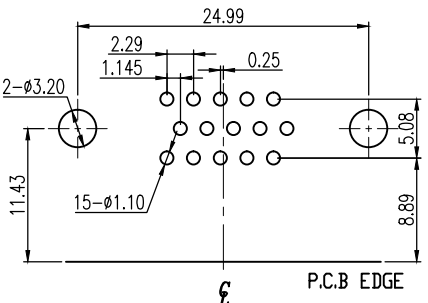

RECOMMENDED P.C.B LAYOUT
INSPECTION DIMENSION:(A)~(H)

		FEN YING®		ENTERPRISES CO.,LTD	
A0		An issue.		2012.08.07	
REV.	CONTENTS		DATE		
①	Drawed		Shao Jianfeng		
	Designed		He Wei		
	Approval		Lee Jun De		
UNLESS OTHERWISE SPECIFIED TOLERANCE mm:	00	= ±0.25	Scale	1:1	Size
	.000	= ±0.13	SHEET	1	Units
Ang:	0.0	= ±2°			mm
Title:			D112 SERIES		
			HIGH DENSITY D-SUB CONNECTOR 0.35"(8.89mm) FOOTPRINT,RIGHT ANGLE		
File NO.		C-ED-B-D112-141			
Drawing NO.		D112H1S1X22B13N0			

1 2 3 4 5 6 7 8