

RECOMMENDED P.C.B LAYOUT  
INSPECTION DIMENSION:(A)~(H)

**SPECIFICATIONS**

1. CENTRONIC
- 1.1 Voltage: 250 VAC(RMS) Max.
- 1.2 Current Rating: 1 Ampere per Contact
- 1.3 Contact Resistance: 30 Milliohms Max.
- 1.4 Insulation Resistance: 1000 Megohms Min.
- 1.5 Dielectric Withstanding Voltage: 1000 VAC(RMS)
- 1.6 Contact Insertion Force: 25 pounds. Maximum.
- 1.7 Contact Separation Force: 2 pounds. Minimum.
- 1.8 Operating Temperature: -55°C to +105°C

**NOTES**

1. MATERIAL:  
Housing:PBT, UL 94V-0, Color:Blue.  
Terminal:Copper Alloy.  
Shell:SPCC.  
Boardlock:Copper Alloy.  
Rivet:Copper Alloy.  
Wire Spring:Steel.
2. FINISH:  
Terminal:Gold Plated over Nickel at Contact Area.  
Tin Plated over Nickel at Solder Area.  
Shell:Nickel Plated.  
Boardlock:Tin Plated.  
Rivet:Nickel Plated.  
Wire Spring:Nickel Plated.
3. This Product is RoHs Compliance Product.

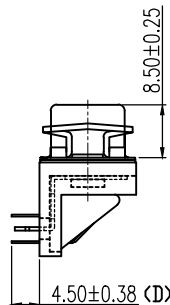

**DA57XXX XXXXXXXXN2**

**SERIES NO.** N: IT'S COMPLIANT WITH RoHS

**NUMBER OF POSITION**  
B1: 14-POSITION  
B2: 24-POSITION  
B3: 36-POSITION  
B4: 50-POSITION

**CONTACT STYLE**  
S: SOCKET  
P: PLUG

**CONTACT PIN LONG & MATERIALS**  
B: 2.54 & PHOSPHOR BRONZE  
C: 3.2 & PHOSPHOR BRONZE  
D: 4.5 & PHOSPHOR BRONZE

**CONTACT FINISH**  
7: C/F MATTIE TIN  
8: 15μ" GOLD MATTIE TIN  
9: 30μ" GOLD MATTIE TIN  
B: 10μ" GOLD MATTIE TIN

**FRONT SHELL FINISH**  
1: TIN  
2: NICKEL

**INSULATOR MATERIALS**  
1: PBT  
3: PA6T

**COLOR STYLE**  
1: BLACK  
2: BLUE  
9: COMMON BLUE

**FLANGE MOUNTING OPTION**  
1: #4-40 THREADED HOLE  
2: M3 THREADED HOLE  
3: ∅3.05mm CLEAR HOLE  
E: #4-40 THREADED HOLE WITH #4-40UNC SCREWLOCK INSTALLED (5.8x13.0)

**BOARD MOUNTING OPTION**  
0: NONE  
1: #4-40 THREADED HOLE  
2: 2-FINGER BOARDLOCK  
5: ∅3.05mm CLEAR HOLE

		<b>FEN YING®</b>		<b>ENTERPRISES CO.,LTD</b>	
<b>A0</b>	An issue.			<b>2020.09.08</b>	
<b>REV.</b>	<b>CONTENTS</b>			<b>DATE</b>	
	Drawn	Shao Jianfeng		Title: <b>DA57 SERIES</b>	
	Designed	He Wei			
	Approval	Lee Jun De			
<small>UNLESS OTHERWISE SPECIFIED TOLERANCE mm:</small>	Scale	1:1	Size	A4	File NO.
∅0 = ±0.25					C-ED-B-DA57-097
.000 = ±0.13	SHEET	1	Units	mm	Drawing NO.
Ang 0.0 = ±2°					DA57B3SDX22221N2