

## SPECIFICATIONS

- HDMI
- 1.1 Voltage: 40 VAC(RMS) Max.
- 1.2 Current Rating: 0.5 Ampere per Contact
- 1.3 Contact Resistance: 30 Milliohms Max.
- 1.4 Insulation Resistance: 100 Megohms Min.
- 1.5 Dielectric Withstanding Voltage: 500 VAC(RMS)
- 1.6 Total Mating Force: 4.5 Kgf Max.
- 1.7 Total Unmating Force: 1.0 Kgf Min.
- 1.8 Operating Temperature: -55°C to +85°C

## NOTES

- MATERIAL:  
Housing:LCP, UL 94V-0, Color:Black.  
Terminal:Copper Alloy.  
Shell:Brass.
- FINISH:  
Terminal:Gold Plated over Nickel at Contact Area.  
Tin Plated over Nickel at Solder Area.  
Shell:Solderable Nickel Plated.
- This Product is RoHS Compliance Product.

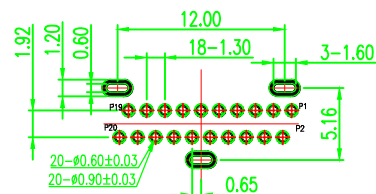
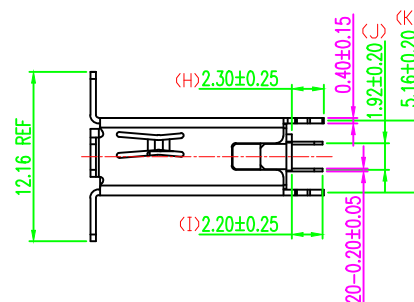
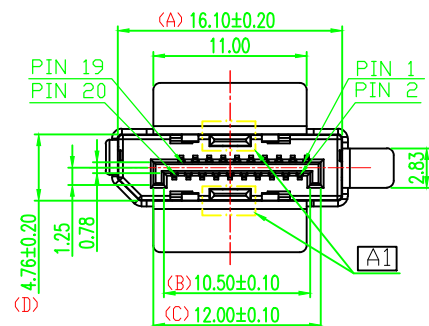

RECOMMENDED P.C.B. LAYOUT  
INSPECTION DIMENSION:(A)~(K)

SERIES NO.	DP02XXX 1XXX0XXN0
NUMBER OF POSITION	20: 20-POSITION
CONTACT STYLE	S: SOCKET
CONTACT MATERIALS	1: BRASS
CONTACT FINISH	1: G/F BRIGHT TIN 3: 15u" BRIGHT TIN 4: 30u" BRIGHT TIN 7: G/F MATTE TIN 8: 15u" MATTE TIN 9: 30u" MATTE TIN
INSULATOR MATERIALS	1: PBT 2: LCP 3: PA9T
COLOR STYLE	1: ALL BLACK
STYLE	2: Short flanging & TRIPLE ARROWHEAD BOARDLOCK 3: Long flanging & TRIPLE ARROWHEAD BOARDLOCK
FRONT SHELL FINISH	8: SOLDERABLE NICKEL

A1	A1 change	2018.06.11	<b>FEN YING®</b> <b>ENTERPRISES CO.,LTD</b>	
A0	An issue.	2015.08.28		
REV.	CONTENTS	DATE	Title: <u>DP02 SERIES</u>	
 UNLESS OTHERWISE SPECIFIED TOLERANCE mm .00 = ±0.25 .000 = ±0.13 Ang: 0.0 = ±2°	Drawn	Yang Xiang	File NO. C-ED-B-DP02-001 Drawing NO. DP0220S1X83012N0	
	Designed	He Wei		
	Approval	Lee Jiun De		
	Scale	1:1	Size	A4
SHEET 2-2		Units	mm	